

# □ Lift Hidraulic cu Apa

X18 • Un lift magic care foloseste APA ca sa ridice si sa coboare lucruri!

## De ce ai nevoie?

• Placi lemn cadru/coloane	• 2 seringi mari	• Tub flexibil transparent
• Ax si ghidaje	• Platforma ridicat	• Suruburi/cleme
• Surubelnita	• Apa (separat)	• Stifturi
• Coliere		

## Pasii de asamblare

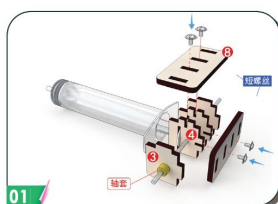

▶ ①将4号板卡在注射器两边, 穿上铁轴。②安装好3号板和轴套。③最后用短螺丝把8号板固定在4号板上。

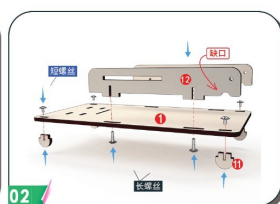

▶ ①两块12号板用长螺丝固定在1号板上。(注意区分12号板和2号板) ②用短螺丝把11号板固定在1号板底下。

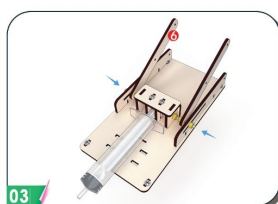

▶ ①把步骤1部件安装在步骤2部件上, 套上轴套。②注意, 轴套需要内外都装一个。

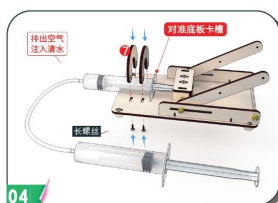

▶ ①先将注射器里面的空气排空, 然后注满水, 用水管把两个注射器连接在一起。②用7号板卡着注射器安装在底板上, 用长螺丝固定。

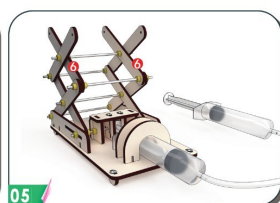

▶ 如图所示, 把所有的6号板用铁轴和轴套穿起来。注意穿轴方向。

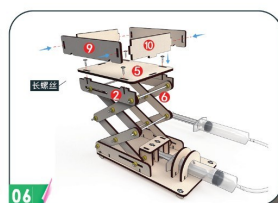

▶ ①把2号板用长螺丝, 固定在5号板上。②9号板和10号板安装在5号板上。③把整体用铁轴安装在6号板上, 用轴套固定, 即可完成安装!

### 1 Cadrul de baza

Fixeaza baza (1) cu coloanele (6 si 7) folosind axul central. Coloanele drepte!

### 2 Suportul superior

Prinde placa superioara (2) cu stifturi. Zona marcata NU se atinge.

### 3 Platforma de ridicat

Monteaza platforma pe ghidaje. Trebuie sa alunece usor sus-jos.

### 4 Umple seringile cu apa!

Umple ambele seringi cu apa pana la jumatate. Conecteaza tubul intre ele, fara bule.

### 5 Fixeaza seringile

Prinde seringile pe cadru cu colierele. Daca sunt bule in tub, scoate-le apasand incet.

### 6 Testeaza liftul!

Apasa pe o seringa - platforma URCA! Apasa pe cealalta - COBOARA!

## ATENȚIE!

- Nu folosi prea multa forta cu seringile - pot iesi!
- Ai grija sa nu versi apa pe podea.
- Tubul trebuie fara bule pentru ca liftul sa functioneze.

## Stiai ca...?

- Se numeste 'presiune hidraulica' - asa functioneaza si macaralele reale!
- Incearca cu diferite greutati pe platforma!